

Housing Project: **Maitreye** First Phase

Project Holders: Joseba and Vijaya D.
Architect: Sonali, Metamorphosis Architecture Unit.
Structural engineer: Dr. R. Ambalavanan, IIT Chennai.
Contractor: Dhanapal, Auronirmata.
Plumbing engineer: Govind Ranjan
Construction started : Oct. 2008
Status: Under construction
Target date of completion: Feb 2011
Site: Residential Zone, Sector 2

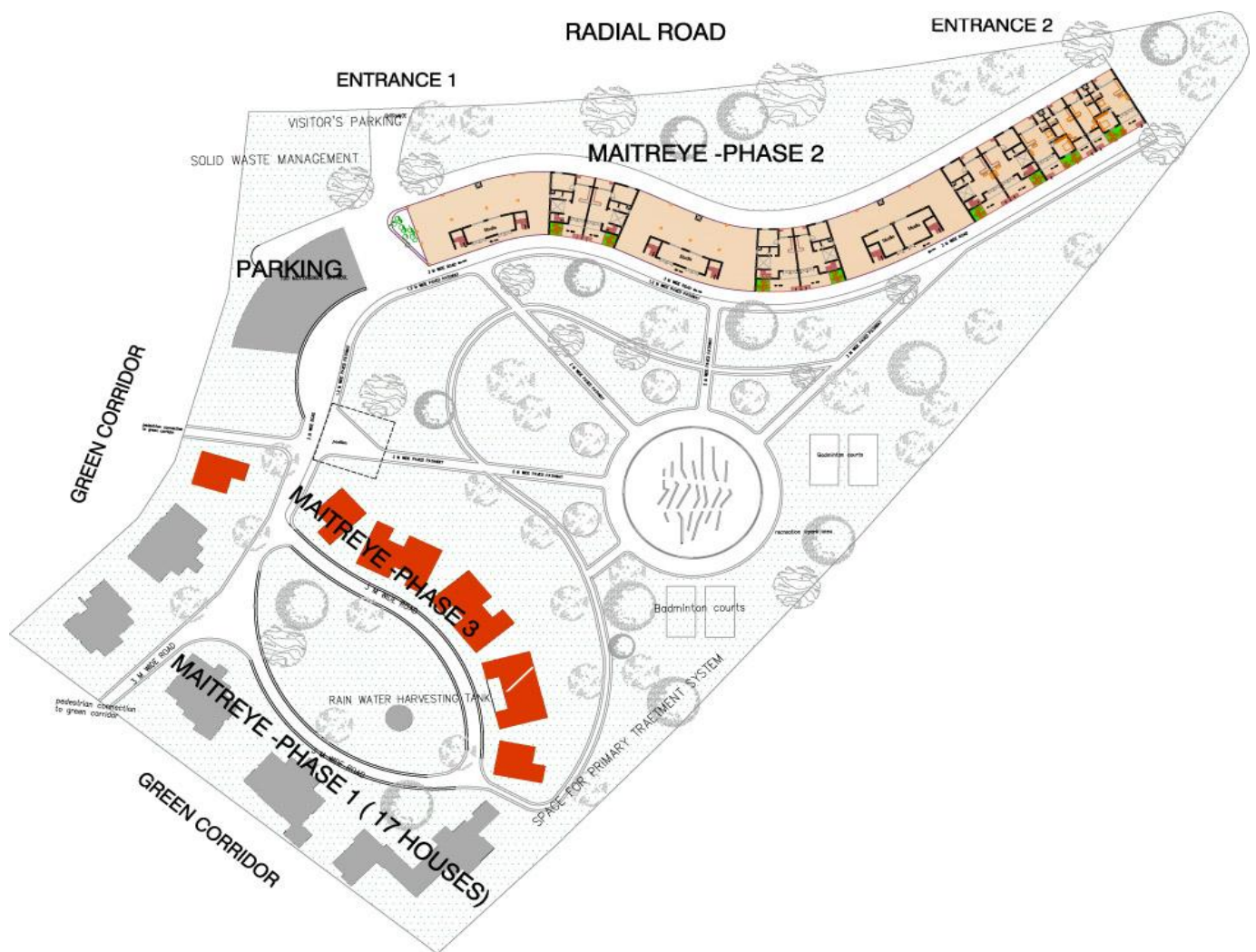

MAITREYE SITE PLAN- PHASE 1 ,PHASE 2 ,PHASE 3

Final Site Plan

Maitreye is a residential project situated in the Residential Zone of Auroville. The aim is to provide various types of housing for approximately 250 residents. In the first phase, 17 houses are being constructed. There are units for single persons, couples and families.

MAITREYEE

LOCATION AND SITE PLAN



First Site Layout

"The Maitreyee Project aims to alleviate one of the biggest problems that Auroville is facing - an acute shortage of housing. This Project seeks to provide various models of houses for a total of approximately 250 residents. The main objective of Maitreyee Project is to offer affordable housing facility with good quality of construction."



Maitreyee housing project is planned on a plot area of approximately 27,729 sq.m. (6.8 acres) 2.75 hectares in the Residential Zone. The is a wedge shaped plot located in sector 2 of the RZ, between a radial road (North), the outer ring road (East) and a green corridor on the west. The access to the site will be from the radial road.

Maitreyee is intended to cater for the needs of Newcomers and Aurovilians with limited resources for their housing needs. Sonali characterizes Maitreyee's method of construction as cost-effective, which focuses on a less costly raw structure by having random rubble masonry rather than reinforced concrete foundation and by making the whole structure load-bearing, using frame construction only for lateral ties against earthquake forces. The external walls are constructed by laying two hollow fired bricks side by side, creating two different cavities to dampen sound as well as provide thermal insulation. The other problem we have here is high humidity, so all the houses in Maitreyee have cross-ventilation. Also the rooms have high ceilings and the windows can be opened at different heights to maximize the air flow. Moreover the roof slabs are also made of hollow terracotta blocks for thermal insulation and to save on the amount of concrete used.



Singles and Couples

Maitreye gives the choice of 3 models of finishing thereby allowing users to select as per the budget and also have the same floor space area which can be upgraded later. Maitreye's infrastructure will focus on the efficient water management with waste water treatment system and a rain water harvesting tank to feed the common laundry .

Solar water heaters are installed as per the clients' request.

Maitreye has tried to conserve almost all the valuable trees on the site and at places the location of the house was adjusted to save trees.

The landscaping planned will incorporate all the existing trees and will focus on indigenous species of plants. Maitreye also plans to develop a community garden for fruits and medicinal plants which will be watered by the waste water treatment system.

VIEWS

Ground floor

First floor

Key Plan

A	Built up Area	127.03sq.m
B	Carpet Area	106.71sq.m
C	Covered Verandah	25.63 sq.m
D	Roof Overhang	26.31 sq.m
E	Open to sky Terrace	63.04 sq.m
F	Staircase	nil
G	Gross Built up	
	A + (C/2) + (D/3) + (E/2)	148.6 sq.m
H	Occupancy	3- 5persons

Family House
Type 1 (3 bedrooms)

Family Houses

At present Maitreye residents include 2 houses for Newcomers, 11 Indians, 4 French, 1 American, 2 Spanish, 2 Russians, 1 Ethiopian, and 1 studio.



Maiteye 1st phase under construction

